



SCHIER

GREAT BASIN™

LEGACY

NEW

No Flow Control

Safety Star®

More Solids Capacity

NO LONGER AVAILABLE

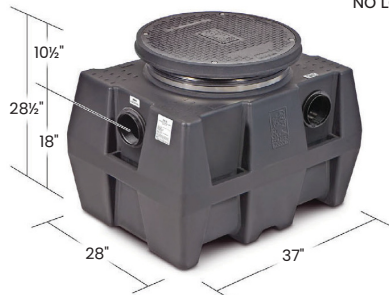

GB-50

RELEASED JULY 2020



NO LONGER AVAILABLE



GB-75

RELEASED JULY 2020



NO LONGER AVAILABLE



GB-250

RELEASED MAR 2020



NO LONGER AVAILABLE



GB-1000

NEW RELEASED NOV 2021



BUILT-IN FLOW CONTROL

All legacy models feature built-in flow control



NO FLOW CONTROL

All new models are ASME certified (Type D) with NO flow control





GREAT BASIN® GREASE INTERCEPTORS

	GB-50		GB-75		GB-250		GB-1000	
	LEGACY	NEW	LEGACY	NEW	LEGACY	NEW	LEGACY	NEW
Flow Rate	50 GPM	50 GPM	75 GPM	75 GPM	100/200 GPM	100/200 GPM	100 GPM	100/200 GPM
Grease Capacity	249 lbs.	439 lbs.	653 lbs.	861 lbs.	1,751/1,196 lbs.	1,895/1,196 lbs.	6,547 lbs.	5,495/4,959 lbs.
Solids Capacity	12.5 gal.	13 gal.	19.2 gal.	31 gal.	21 gal.	69 gal.	103 gal.	211 gal.
Liquid Capacity	52 gal.	65 gal.	125 gal.	125 gal.	275 gal.	277 gal.	1,010 gal.	1,000 gal.
Weight w Cast Cover(s)	147 lbs.	148 lbs.	185 lbs.	190 lbs.	340 lbs.	376 lbs.	1,516 lbs.	824 lbs.
Covers	C24H, C24HP	C24H2, C24HP	C24H, C24HP	C24H2, C24HP	C24H, C24HP	C24H2, C24HP	C24H2, C24HP	C24H2, C24HP
Flow Control Cartridge	Yes	No	Yes	No	Yes	No	Yes	No
Safety Star	No	Yes	No	Yes	No	Yes	Yes	Yes
Risers	SR24, LR24	FCR2	SR24, LR24	FCR2	SR24, LR24	FCR2	FCR2	FCR2
Height	28.5" (72 cm)	28.5" (72 cm)	38.5" (98 cm)	40" (102 cm)	51.5" (131 cm)	44" (112 cm)	77" (196 cm)	71.25" (181 cm)
Width	28" (71 cm)	32.25" (82 cm)	32" (81 cm)	33" (84 cm)	33.5" (85 cm)	33" (84 cm)	68" (173 cm)	73.75" (187 cm)
Length	37" (94 cm)	37" (94 cm)	46" (117 cm)	47" (119 cm)	68" (173 cm)	87" (221 cm)	90" (229 cm)	92" (234 cm)
Top to Inlet Center	10.5" (27 cm)	10.5" (27 cm)	12.5" (32 cm)	13.5" (34 cm)	13.5" (35 cm)	13.5" (34 cm)	18" (46 cm)	13.25" (34 cm)
Bottom to Inlet Center	18" (46 cm)	18" (46 cm)	26" (81 cm)	26.5" (67 cm)	38" (97 cm)	30.5" (77 cm)	59" (150 cm)	58" (147 cm)

ACCESSORIES

SR24
short riser
20"



LR24
long riser
35"



RISERS



Safety Star®
access restrictor



For New models

FCR2
field cut riser
32"

For Legacy and New models



C24H composite



C24HP cast iron

COVERS



C24H2 composite



C24HP cast iron

AK1

Anti-flotation Anchor Kit

For Legacy and New models

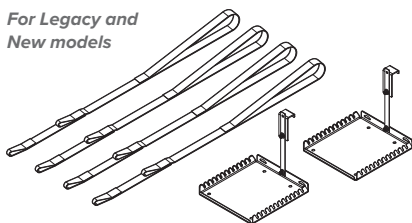

AK3

Anti-flotation Anchor Kit

For GB-1000 and all Big Foot™ models

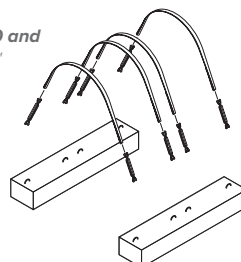

PP3

Pumpout Port Kit

For Legacy and New models

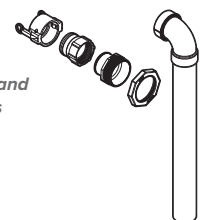

LIFETIME GUARANTEED **GREASE INTERCEPTORS**

Made in the USA